

High Purity BioPharm Fittings

Weld x Weld x Clamp Short Outlet Tees - T7WWMS

Size	Dimensions		PL finish - SF1 Part #	PM finish - SF4 Part #
	A	B		
1/2"	3.750"	1.000"	T7WWMS-050PL	T7WWMS-050PM
3/4"	4.000"	1.125"	T7WWMS-075PL	T7WWMS-075PM
1"	4.250"	1.125"	T7WWMS-100PL	T7WWMS-100PM
1 1/2"	4.750"	1.375"	T7WWMS-150PL	T7WWMS-150PM
2"	5.750"	1.625"	T7WWMS-200PL	T7WWMS-200PM
2 1/2"	6.250"	1.825"	T7WWMS-250PL	T7WWMS-250PM
3"	6.750"	2.125"	T7WWMS-300PL	T7WWMS-300PM
4"	8.250"	2.750"	T7WWMS-400PL	T7WWMS-400PM

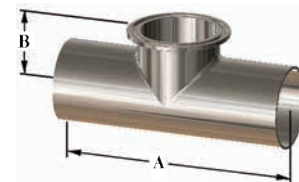

BPE Table DT-4.1.2-2

Sanitary Fittings

Weld x Weld x Clamp Tees - T7WWM

Size	Dimensions		PL finish - SF1 Part #	PM finish - SF4 Part #
	A	B		
1/2"	3.750"	2.250"	T7WWM-050PL	T7WWM-050PM
3/4"	4.000"	2.375"	T7WWM-075PL	T7WWM-075PM
1"	4.250"	2.625"	T7WWM-100PL	T7WWM-100PM
1 1/2"	4.750"	2.875"	T7WWM-150PL	T7WWM-150PM
2"	5.750"	3.375"	T7WWM-200PL	T7WWM-200PM
2 1/2"	6.250"	3.625"	T7WWM-250PL	T7WWM-250PM
3"	6.750"	3.875"	T7WWM-300PL	T7WWM-300PM
4"	8.250"	4.750"	T7WWM-400PL	T7WWM-400PM

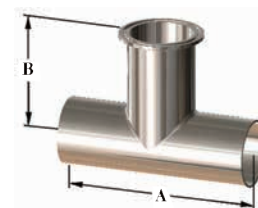

Clamp x Clamp x Clamp Tees - T7MP

Size	Dimensions		PL finish - SF1 Part #	PM finish - SF4 Part #
	A	B		
1/2"	4.500"	2.250"	T7MP-050PL	T7MP-050PM
3/4"	4.750"	2.375"	T7MP-075PL	T7MP-075PM
1"	5.250"	2.625"	T7MP-100PL	T7MP-100PM
1 1/2"	5.750"	2.875"	T7MP-150PL	T7MP-150PM
2"	6.750"	3.375"	T7MP-200PL	T7MP-200PM
2 1/2"	7.250"	3.625"	T7MP-250PL	T7MP-250PM
3"	7.750"	3.875"	T7MP-300PL	T7MP-300PM
4"	9.500"	4.750"	T7MP-400PL	T7MP-400PM

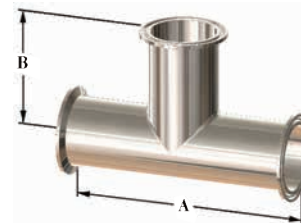

BPE Table DT-4.1.2-4

PL Finish – SF1
 OD = 32R_a Mechanically Polished
 ID = 20R_a Mechanically Polished

PM Finish – SF4
 OD = 32R_a Mechanically Polished
 ID = 15R_a Mechanically Polished and Electropolished